



MASTER-TROL PLUS PACKAGE

RETROFIT APPLICATIONS:

1 LAVATORY & 1 TOILET



Qty: 1



Qty: 1

EZ-MTP PRE-PROGRAMMED SETTINGS:

LAVY: WILL HAVE A 10-SECOND RUN TIME WITHOUT A LOCKOUT TIME PERIOD.

TOILET: WHEN FLUSHED 2 TIMES WITHIN A 5-MINUTE PERIOD, THE FLUSH VALVE WILL BE LOCKED OUT AND WILL BE UNABLE TO FLUSH FOR 15 MINUTES.

ORDER SKU: EZ-MTP-WCL

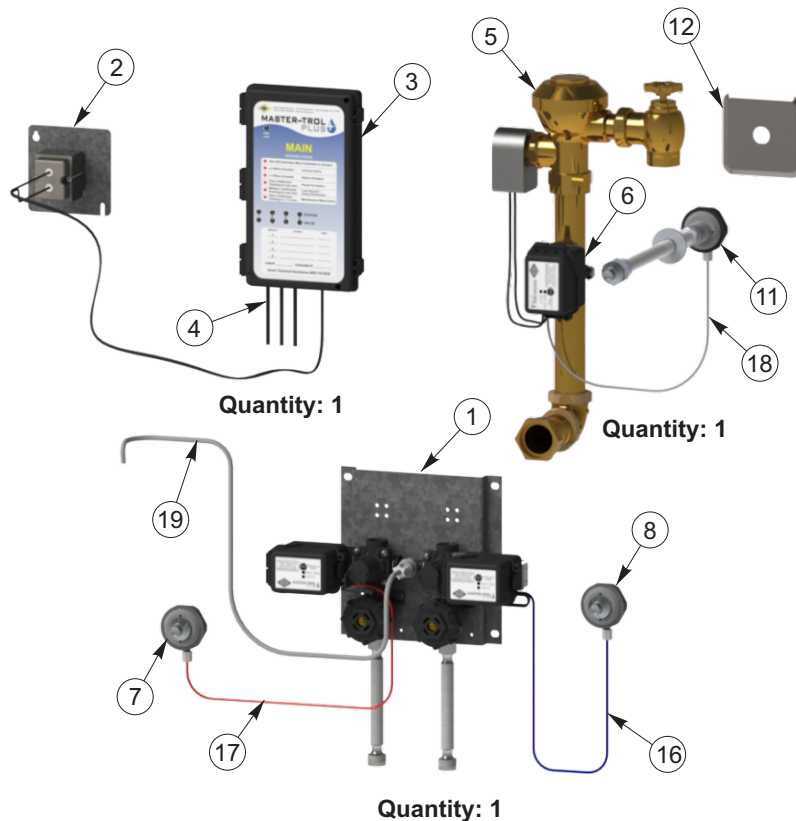

PUSHBUTTONS WILL ACCOMMODATE:

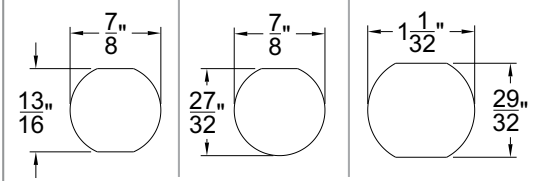

PUSHBUTTON ESCUTCHEONS:

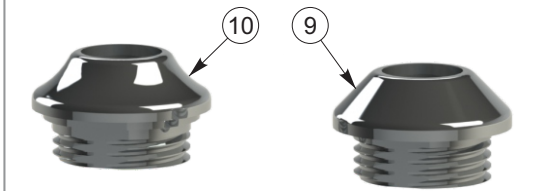

TUBING TO BUBBLER ADAPTERS:

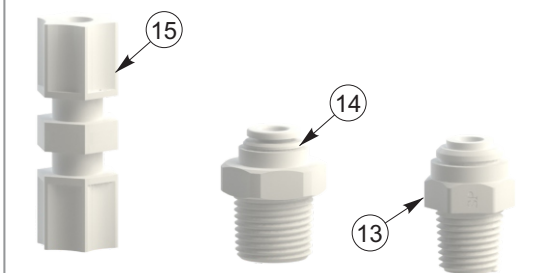

ITEM #	COMPONENTS PROVIDED
1	-MTP2 H&C 0.5 GPM Valve Assembly (Pneumatic)
2	24VAC, 50 VA Transformer with 4" X 4" Mtg. Plate
3	MTP Main Controller
4	MTP Station Cable (CaT 5e) 15'
5	Electronic Solenoid Operated Flush Valve, 1.28 GPF
6	-MTPFV Flush Valve Branch Box Assembly
7	Hot Pushbutton Assembly
8	Cold Pushbutton Assembly
9	7/8" Double "D" Punch Pushbutton Escutcheon
10	1-1/32" Double "D" Punch Pushbutton Escutcheon

ITEM #	COMPONENTS PROVIDED
11	8" Single Temp. Actuated Air-Trol Pushbutton Assembly
12	Anti-Rotational Pushbutton Mounting Plate
13	1/4" O.D. Tube x 1/4" NPT Male Adapter
14	1/4" O.D. Tube x 3/8" NPT Male Adapter
15	1/4" O.D. Tube Union
16	1/8" Blue Tubing for Pneumatic Cold Activation, 10'
17	1/8" Red Tubing for Pneumatic Hot Activation, 10'
18	1/8" Clear Tubing for Pneumatic Flush Valve Activation, 10'
19	1/4" Clear Tubing from Valve Supply to -BP Penal Bubbler, 10'

Please visit www.acorneng.com for most current specifications.

